

NORTH

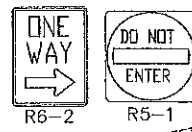

PAVEMENT LEGEND:

- A** CONTRACTION/TRVERSE JOINT WITHOUT DOWEL
- B** LONGITUDINAL CONSTRUCTION JOINTS
- C** 3/4" THK. EXPANSION JOINTS (E.J.)
- D** TYPICAL THICKENED EDGE WITH 3/4" E.J.
- E** JUNCTION BETWEEN NEW ASPHALT AND NEW CONC. PAVEMENT
- F** JUNCTION BETWEEN EXIST. ASPHALT AND NEW CONC. PAVEMENT

LEGEND:

- 2" THK. ASPHALT CONC. PAVEMENT ON 6" THK. GRADED AGGREGATE BASE
- GREEN SPACE (GRASS AREA)
- 8" THK. RIGID CONC. PAVEMENT ON 8" THK. GRADED AGGREGATE BASE
- CONC. WALKWAY OR CONC. SIDEWALK
- DUMPSTER
- NO. OF PARKING SPACES
- REINFORCE CONC. PAVEMENT WITH W2x2

PAVEMENT NOTE:

1. TRAVERSE JOINTS ARE SPACED UP TO A MAXIMUM 12 FT.
2. LONGITUDINAL JOINTS ARE SPACED UP TO A MAXIMUM 12 FT.
3. EXPANSION JOINTS SHALL BE CONSTRUCTED AROUND DRAINAGE/UTILITY STRUCTURES.
4. EXPANSION JOINTS SHALL BE CONSTRUCTED ADJACENT TO CURB, RETAINING WALL AND OTHER RIGID STRUCTURES.

PROJECT DESCRIPTION

ITEM DESCRIPTION	EXISTING	PROPOSED
TOTAL DISTURBED AREA (Ac)	-	0.98 Ac
TOTAL DISTURBED AREA (SF)	-	42,688 SF
IMPERVIOUS AREA (Ac)	-	0.82 Ac
IMPERVIOUS AREA (SF)	-	35,719 SF
PERCENT IMPERVIOUS (%)	-	73.87 %
PARKING SPACES:		
POV	8 SPACES	24 SPACES
HANDICAP	1 SPACES	2 SPACES
TOTAL POV SPACES	9 SPACES	26 SPACES

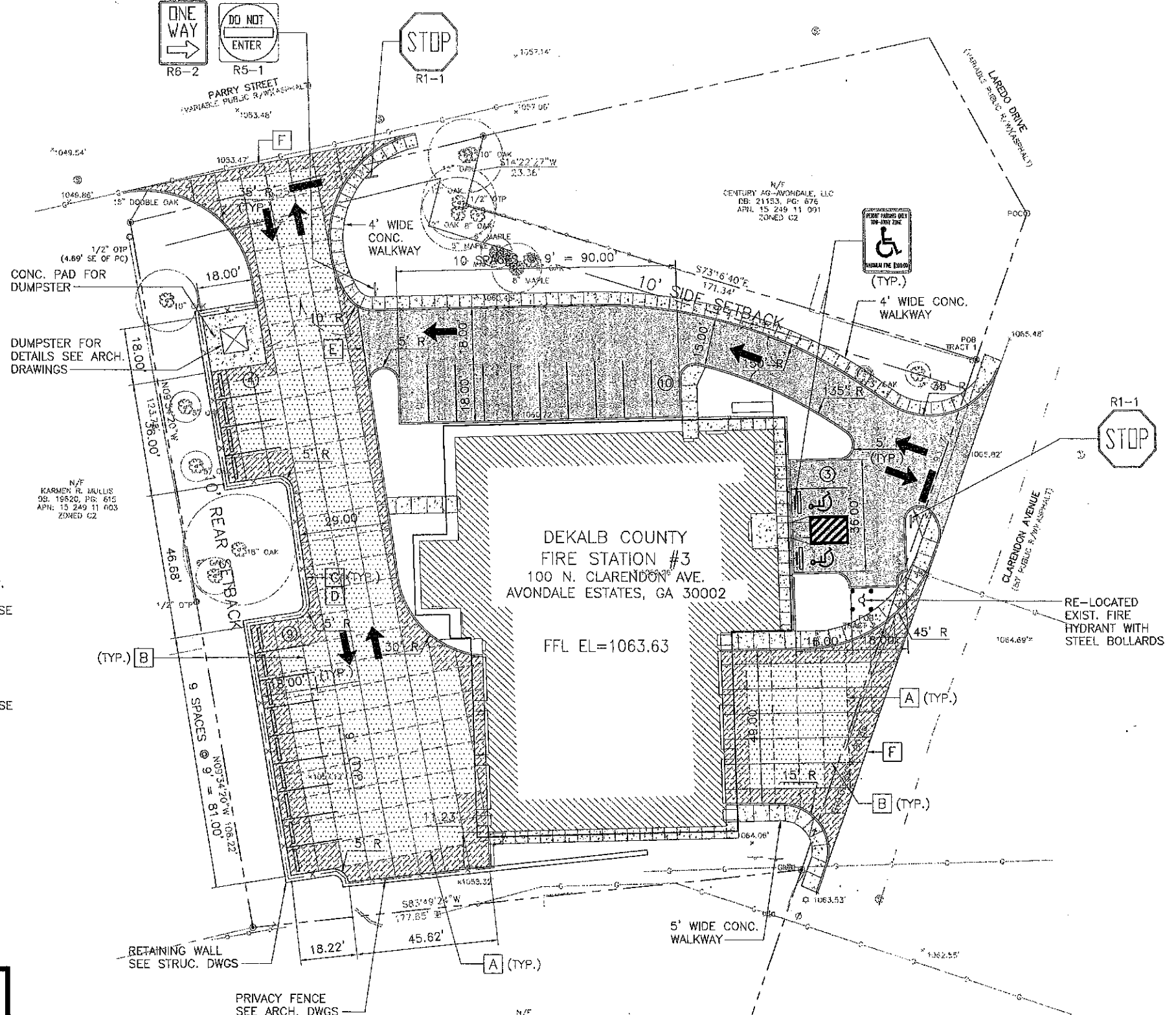
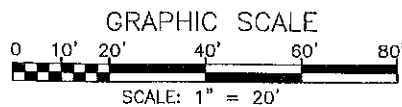

N/F  
CENTURY AG-AVONDALE, LLC  
DB: 20529, PG: 262  
APN: 15 249 11 014  
ZONED C2C2

N/F  
KARMEN R. BRILLUS  
DB: 19620, PG: 615  
APN: 15 249 11 003  
ZONED C2

N/F  
CENTURY AG-AVONDALE, LLC  
DB: 21153, PG: 676  
APN: 15 249 11 091  
ZONED C2

RE-LOCATED  
EXIST. FIRE  
HYDRANT WITH  
STEEL BOLLARDS